

UNIT, DIRECT SUPPORT, AND GENERAL SUPPORT MAINTENANCE
REPAIR PARTS AND SPECIAL TOOLS LIST
TRUCK, 5-TON, 6X6, M809 SERIES TRUCKS (DIESEL)

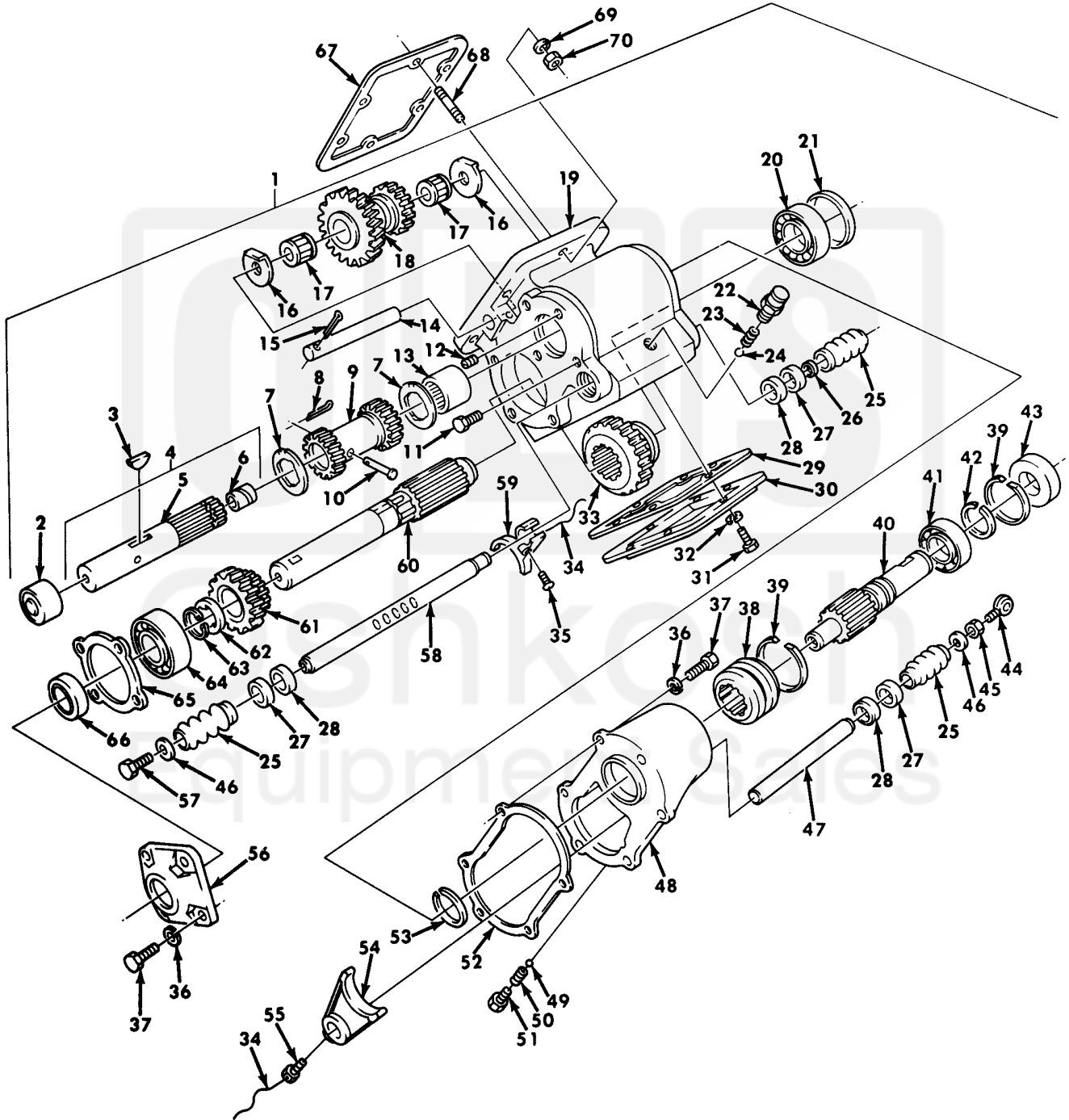

Figure 418. Transmission Power Takeoff Assembly and Mounting Hardware.

(1) ITEM NO	(2) SMR CODE	(3) NSN	(4) CAGEC	(5) PART NUMBER	(6) DESCRIPTION AND USABLE ON CODE (UOC)	(7) QTY
GROUP 2004 POWER TAKEOFF ASSEMBLY						
FIG. 418 TRANSMISSION POWER TAKEOFF ASSEMBLY AND MOUNTING HARDWARE						
1	PAFFF	2520-00-740-9589	19207	7409589	POWER TAKEOFF, TRANS..... UOC: 620, 627, 633	1
2	PAFZZ	3110-00-183-6723	24617	713421	. BEARING..... UOC: 620, 627, 633	1
3	PAFZZ	5315-00-058-8581	96906	MS35756-109	. KEY, WOODRUFF..... UOC: 620, 627, 633	1
4	PAFZZ	2520-00-740-9594	19207	7409594	. SHAFT REVERSE GEAR..... UOC: 620, 627, 633	1
5	XAFZZ		19207	10900574	. . SHAFT..... UOC: 620, 627, 633	1
6	PAFZZ	3120-00-737-3115	19207	7373115	. . BEARING, SLEEVE..... UOC: 620, 627, 633	1
7	PAFZZ	5310-00-706-1281	19207	7061281	. WASHER, THRUST..... UOC: 620, 627, 633	2
8	PAFZZ	5315-00-839-2326	96906	MS24665-281	. PIN, COTTER..... UOC: 620, 627, 633	1
9	PAFZZ	2520-00-740-9587	19207	7409587	. GEAR REVERSE SHAFT..... UOC: 620, 627, 633	1
10	PAFZZ	5315-01-208-5492	19207	8728251	. PIN, STRAIGHT, HEADED..... UOC: 620, 627, 633	1
11	PAFZZ	5306-00-226-4822	80204	B1821BH031C050N	. BOLT, MACHINE..... UOC: 620, 627, 633	2
12	PAFZZ	4730-00-018-9566	81348	WW-P-471ACABCA	. PLUG, PIPE..... UOC: 620, 627, 633	1
13	PAFZZ	3110-00-183-6723	96906	MS17131-35	. BEARING, ROLLER, NEED..... UOC: 620, 627, 633	1
14	PAFZZ	3040-00-706-1266	95019	9P21	. SHAFT, SHOULDERED..... UOC: 620, 627, 633	1
15	PAFZZ	5315-00-013-7258	96906	MS24665-497	. PIN, COTTER..... UOC: 620, 627, 633	1
16	PAFZZ	5310-00-753-8656	19207	7538656	. WASHER, KEY..... UOC: 620, 627, 633	2
17	PAFZZ	3110-00-227-3074	19207	7538658	. BEARING, ROLLER, JOUR..... UOC: 620, 627, 633	2
18	PAFZZ	3020-00-740-9586	19207	7409586	. GEAR CLUSTER..... UOC: 620, 627, 633	1
19	PAFZZ	2520-00-706-1160	19207	7061160	. CASE NAME PLATE..... UOC: 620, 627, 633	1
20	PAFZZ	3110-00-100-3119	60038	700080	. CONE AND ROLLERS, TA..... UOC: 620, 627, 633	1
21	PAFZZ	2520-00-706-1265	19207	7061265	. SPACER POWER TAKE O..... UOC: 620, 627, 633	1
22	PAFZZ	2520-00-104-4603	19207	5226140	. RETAINER, SHIFTER SH..... UOC: 620, 627, 633	1
23	PAFZZ	5360-00-692-6128	19207	8331558	. SPRING, HELICAL, COMP..... UOC: 620, 627, 633	1
24	PAFZZ	3110-00-100-6158	96906	MS19059-2422	. BALL, BEARING..... UOC: 620, 627, 633	1
25	PAOZZ	9390-00-706-1278	19207	7061278	. BELLOWS, PROTECTION..... UOC: 620, 627, 633	3
26	PAOZZ	5310-00-740-9595	19207	7409595	. WASHER, FLAT..... UOC: 620, 627, 633	1
27	PAOZZ	5330-00-737-6534	19207	7376534	. RETAINER, PACKING..... UOC: 620, 627, 633	3
28	PAFZZ	5330-01-143-1211	19207	7061272	. SEAL, PLAIN ENCASED..... UOC: 620, 627, 633	3
29	PAFZZ	5330-00-234-3317	19207	8327322	. GASKET..... UOC: 620, 627, 633	1

(1) ITEM NO	(2) SMR CODE	(3) NSN	(4) CAGEC	(5) PART NUMBER	(6) DESCRIPTION AND USABLE ON CODE (UOC)	(7) QTY
30	PAFZZ	5340-00-354-0771	19207	5323473	.COVER,ACCESS..... UOC: 620, 627, 633	1
31	PAFZZ	5305-00-144-1495	19207	10910354	.SCREW,MACHINE..... UOC: 620, 627, 633	6
32	PAFZZ	5310-00-627-6128	96906	MS35335-35	.WASHER,LOCK..... UOC: 620, 627, 633	6
33	PAFZZ	3020-00-318-0908	19207	7538671	.GEAR,SPUR..... UOC: 620, 627, 633	1
34	MFFZZ		96906	MS20995F41XAR	.WIRE,NONELECTRICAL MAKE FROM WIRE,P/N MS20995F41..... UOC: 620, 627, 633	1
35	PAFZZ	5306-00-404-0075	19207	8344155	.BOLT,MACHINE..... UOC: 620, 627, 633	1
36	PAFZZ	5310-00-407-9566	96906	MS35338-45	.WASHER,LOCK..... UOC: 620, 627, 633	9
37	PAFZZ	5306-00-225-8499	96906	MS90725-34	.BOLT,MACHINE..... UOC: 620, 627, 633	9
38	PAFZZ	2520-00-706-1210	19207	7061210	.CLUTCH,SLIDING SLEE..... UOC: 620, 627, 633	1
39	PAFZZ	5325-00-706-1280	19207	7061280	.RING,RETAINING..... UOC: 620, 627, 633	2
40	PAFZZ	3040-00-706-1211	95019	3P136	.SHAFT,SHOULDERED..... UOC: 620, 627, 633	1
41	PAFZZ	3110-00-144-8518	21450	700078	.BEARING,BALL,ANNULA..... UOC: 620, 627, 633	1
42	PAFZZ	5325-01-125-6136	19207	7061277	.RING,RETAINING..... UOC: 620, 627, 633	1
43	PAFZZ	5330-00-559-8733	19207	7061271	.SEAL,PLAIN ENCASED..... UOC: 620, 627, 633	1
44	PFOZZ	5306-00-493-5315	95019	36P1	.BOLT,EYE..... UOC: 620, 627, 633	1
45	PAOZZ	5310-00-918-6921	96906	MS35691-20	.NUT,PLAIN,HEXAGON..... UOC: 620, 627, 633	1
46	PAOZZ	5310-00-080-6004	96906	MS27183-14	.WASHER,FLAT..... UOC: 620, 627, 633	2
47	PAFZZ	3040-00-706-1268	19207	7061268	.SHAFT,SHOULDERED..... UOC: 620, 627, 633	1
48	XAFZZ		19207	7061194	.HOUSING..... UOC: 620, 627, 633	1
49	PAFZZ	3110-00-100-6155	96906	MS19059-2418	.BALL,BEARING..... UOC: 620, 627, 633	1
50	PAFZZ	5360-00-521-4784	19207	5214784	.SPRING,HELICAL,COMP..... UOC: 620, 627, 633	1
51	PAFZZ	5365-00-769-6481	19207	7696481	.PLUG,MACHINE THREAD..... UOC: 620, 627, 633	1
52	PAFZZ	5330-00-706-1270	19207	7061270	.GASKET..... UOC: 620, 627, 633	1
53	PAFZZ	5325-00-706-1276	19207	7061276	.RING,RETAINING..... UOC: 620, 627, 633	1
54	PAFZZ	2520-00-706-1274	19207	7061274	.SHIFTER FORK,VEHICU..... UOC: 620, 627, 633	1
55	PAFZZ	5305-00-752-1058	19207	7521058	.SETSCREW..... UOC: 620, 627, 633	1
56	PAFZZ	4730-00-626-2467	56442	2394T2	.FLANGE,PIPE..... UOC: 620, 627, 633	1
57	PAFZZ	5305-00-269-3234	80204	B1821BH038F075N	.SCREW,CAP,HEXAGON H..... UOC: 620, 627, 633	1
58	PAFZZ	3040-00-740-9592	19207	7409592	.SHAFT,SHOULDERED..... UOC: 620, 627, 633	1
59	XDFZZ		19207	7061273	.SHIFTER FORK,NONVEH..... UOC: 620, 627, 633	1
60	PAFZZ	2520-00-740-9593	19207	7409593	.SHAFT OUTPUT..... UOC: 620, 627, 633	1